

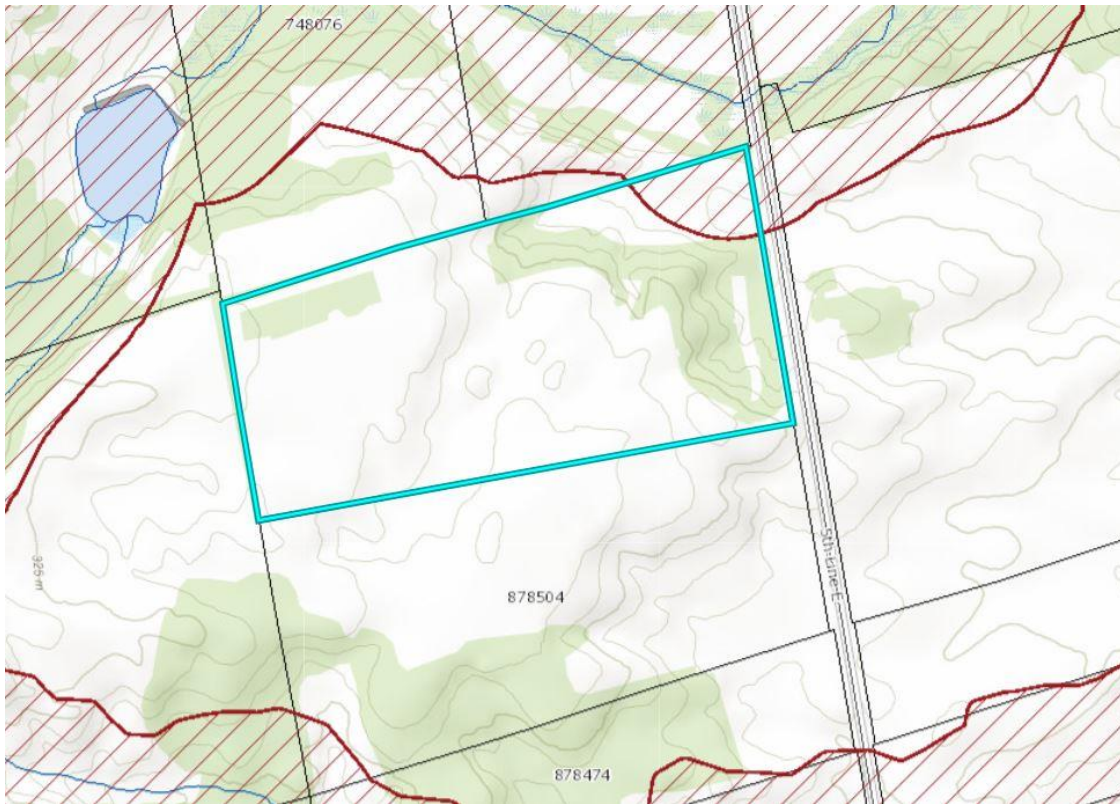

Lot 29, Con 5, Mulmur



Aerial map presented as per NVCA website and is not to be used as a legal description of the property. It is for information purposes only and may not represent actual or current conditions.

<p>Base Mapping</p> <ul style="list-style-type: none"> <input type="checkbox"/> NVCA Jurisdiction <input type="checkbox"/> Lower Tier Jurisdiction <input type="checkbox"/> Dufferin County/Grey County Assessment Parcels 	<p>Nvca Regulated Areas</p> <ul style="list-style-type: none"> <input checked="" type="checkbox"/> NVCA Regulated Area 	<p>Building Type</p> <ul style="list-style-type: none"> <input type="checkbox"/> Building Type
<p>Topographic Basemap Features</p> <ul style="list-style-type: none"> Jurisdictional Border First Nations Territory Trail Railway Urban Area Elevation Wooded Area 	<p>Transportation (Roads)</p> <p>Transportation (Roads) > 1:15000</p> <ul style="list-style-type: none"> Highway Major Road Local Road Private, Unassumed and Seasonal Road <p>Transportation (Roads) < 1:15000</p> <ul style="list-style-type: none"> Highway Major Road Local Road Private, Unassumed and Seasonal Road 	<p>Parcels</p> <ul style="list-style-type: none"> <input type="checkbox"/> Assessment Parcel <input type="checkbox"/> Ownership Parcel
<p>Water Features</p> <ul style="list-style-type: none"> River, Stream or Creek Lake, Pond, River or Stream Wetland 	<p>Land Type</p> <ul style="list-style-type: none"> Airport Cemetery Commercial Beach Emergency Service Education Golf Course Health Service Municipal Park Provincial Park Industrial Military 	